

产品参数

频道	100channels	系统频率范围	20-20KHz
接收灵敏度	<-110dBm@20dB SINAD	失真度	<0.05%
信噪比	>85dB	传输距离	>30m
延迟	<5ms	满电工作时间	>6小时(因环境而异)

无线系统

- WX502是一款5.8G无线传输收发系统,适用于3.5mm和6.35mm的音频接口设备,具有抗干扰能力强、穿透障碍物强、稳定传输不卡顿等优点。为了减少信号衰减,无线系统应安装在开阔区域,并且与大的金属物、墙面、障碍物等物体至少保持1.5米的距离,并尽量保证发射器与接收器之间有空旷的信号直射途径。演出前请仔细检查电池电量是否充足,避免因电量不足而无法使用。

产品附件清单

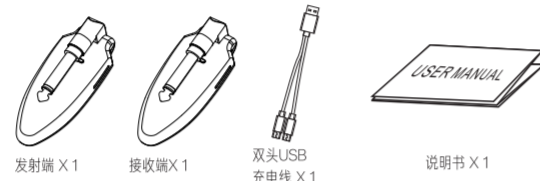

产品介绍说明

WX502出厂默认安装6.35mm音频插头,需要接3.5mm的音频设备时,可拧下6.35mm插头。

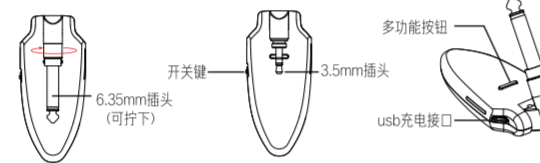

设备开/关机

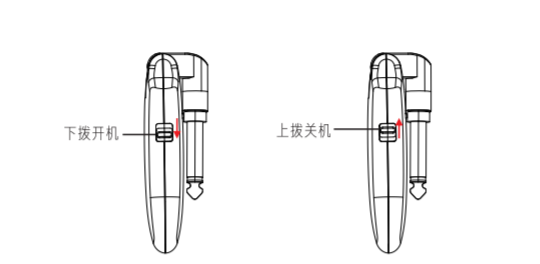

设备充电

- 设备使用的是聚合物锂电池,使用前请先给设备进行充电;长时间不使用,三个月给产品充电一次激活;

- 1.设备配有双头的USB充电线,可同时给发射器和接收端进行充电,请选用5V 2A的充电器进行充电;
- 2.充电状态下电量显示,充电时指示灯如上图所示

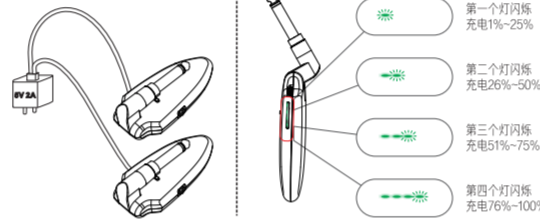

设备测试

- 将发射器接入乐器,接收器接入音响,按下发射器与接收器侧面的开机键,发射端与接收端绿灯常亮即进入工作状态。出现以下情况请按以下方式解决

未匹配成功: 如果出现发射端绿灯亮而接收端红灯闪烁即证明未匹配成功,可重新对设备进行开关机操作。

匹配成功无声音: 如果出现发射端与接收端都是绿灯常亮无声音,演奏无声音,可尝试对产品进行重新配对对码。

跳频: 如果使用期间音频有干扰现象,有可能附近有类似信号在工作,可直接短按发射端的跳频按键进行跳频。

电量检查

- 当设备处于开机时,双击正面按钮侧边4个绿色灯显示当前电量信息,3秒后熄灭。

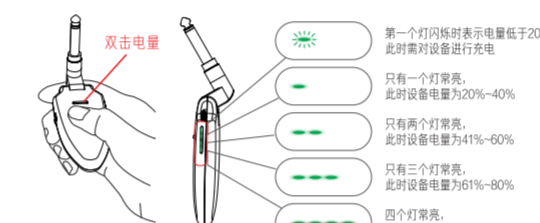

重新对码配对

- 设备在出厂前默认进行过对码设置,产品开机后可直接使用。如出现开机不能直接使用,可重新进行对码设置。

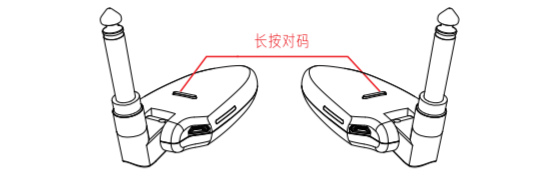

对码: 在关闭所有其他无线设备以后,长按对码按键进行对码,直到发射端(接收端)红灯闪烁后松开按键,大概等1-3分钟左右,发射端与接收端都绿灯常亮时,对码成功。

多对同时使用

- 无线设备系统可10套设备同时使用,无干扰(30平方)。为了避免信号交叉,请对无线收发器一对一的进行开机和测试。在每对无线收发器测试完成后再进行下一对无线收发器开机和测试。测试期间发现有信号干扰的情况下,可选择跳频键进行跳频。

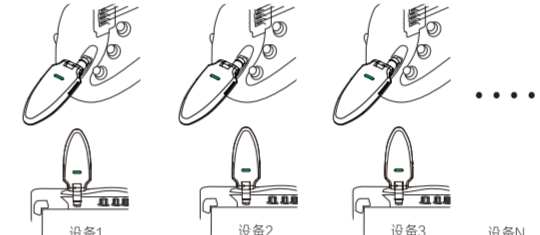

1对多功能

- 一个WX502的发射器可以配合数十个WX502接收器使用
例如: 一个舞台上4个接收设备也可以通过一个WX502发射器与4个WX502接收器进行连接,同时演出。

设备调试: 在关闭所有其他无线设备以后,长按四个接收设备的多功能按钮,直到接收端红灯闪烁后松开按钮,再长按一个发射器设备的多功能按钮,直到发射端红灯闪烁后松开按钮需要大概等20秒左右,发射端与所有接收端都绿灯常亮时,四个接收端可接收一个发射端的信号,即可实现1对多的功能。所有的对码调试时间要在20秒内完成。

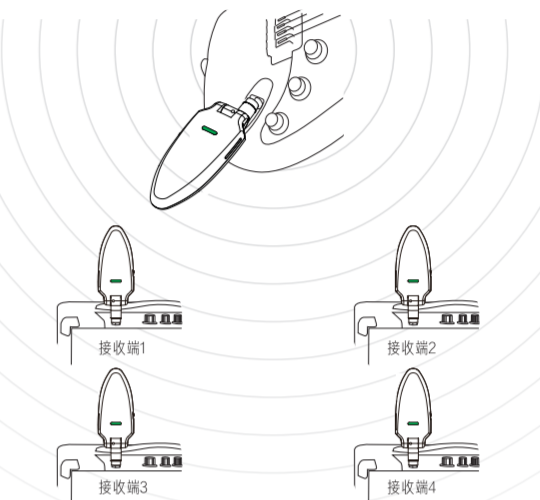

Please read the instructions carefully before using this product

warning: In order to reduce the risk of fire or electric shock, please do not put the equipment in the rain or wet place.
Note: please do not disassemble the equipment without permission. There is no part that can be repaired by the user. Please hand it over to qualified maintenance personnel

- 1 Please use the attached charging line for charging. If you are unsure of the type of power available, please consult your dealer.
- 2 The device has a built-in lithium battery. Please do not put it into the fire or near the heat source.
- 3 This equipment is not waterproof, do not put into water or other liquids.
- 4 Please do not attempt to repair the equipment, because open the lid after may make you touch the danger point voltage or other risks if this equipment is the need for maintenance, please to qualified maintenance personnel for repair.
- 5 If you are not using this product for a long time, you should unplug the charging cable.
- 6 Avoid the power cord being trampled or the position of the socket and the connecting device being too tight at the plug.

COMPANY: SWIFF TECHNOLOGY CO., LTD.
ADDRESS: 5/F, Building B, Hengchangong(Qinghai) Industrial Park,
No.52 Huangling Road, Longhua, Shenzhen, China
Tel: +86 755 2331 1770

CE FCC ID: 2ARWY-WX501 MADE IN CHINA

请在使用本产品前请详细阅读说明

警告: 为了减少火灾或者触电的危险, 请勿将本设备置于雨中或者潮湿的地方
注意: 请勿私自拆卸本设备, 内部没有用户可维修的部件, 请交给合格的维修人员处理

- ①请使用附带的充电线进行充电, 如果不确定可用的电源类型, 请咨询您的经销商。
- ②本设备内置锂电池, 请勿放入火中或热源附近。
- ③本设备没有防水功能, 请勿投入水中或其他液体中。
- ④请勿尝试自行维修本设备, 因为打开盖子后可能会使您触碰到危险电压点或其他风险。如果本设备需要进行维修, 请交给合格的维修人员进行维修。
- ⑤如果您长时间不使用本产品的時候, 应该拔掉充电线。
- ⑥避免电源线被踩踏或者在插头处弯曲和连接设备的位置弯曲的太紧。

制造商: 深圳市瑞孚科技有限公司
制造商地址: 广东省深圳市龙华新区大浪
街道华宇路52号恒昌荣星辉科技园
联系电话: +86 755 2331 1770

CE FCC ID: 2ARWY-WX501 中国制造

Specification

Channel	100 channel	System frequency response	20-20KHz
Distortion	<0.05%	Reception sensitivity	<-110dBm @20db SINAD
Signal-to-noise ratio	>85dB	Transmission distance	>30m
Latency	<5ms	Full working hours	>6 hours (circumstantial)

Wireless System

- WX502 is a 5.8G wireless transmission transceiver system, apply with 6.35mm audio devices, with strong anti-interference ability, through the obstacles of strong, stable transmission no pause etc in order to avoid signal attenuation, wireless system should be close to acting areas as far as possible, and with a large metal, wall, scaffolding and other objects at least keep a distance of 1.5 meters, and as far as possible to ensure that between transmitter and receiver are empty signal direct way. To avoid being unable to use due to low battery, please kindly check the batteries are good before use.

Package contents

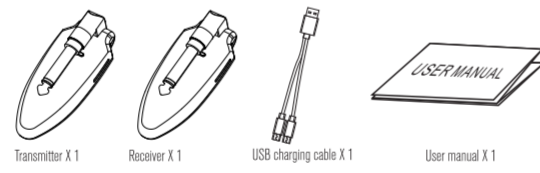

Product Introduction

WX502 factory default installation 6.35mm audio plug, need to connect 3.5mm audio equipment, you can unscrew the 6.35mm plug.

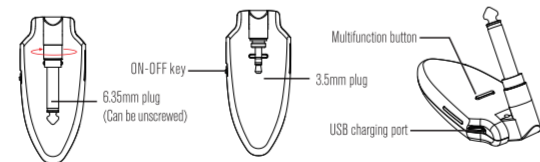

Device on / off

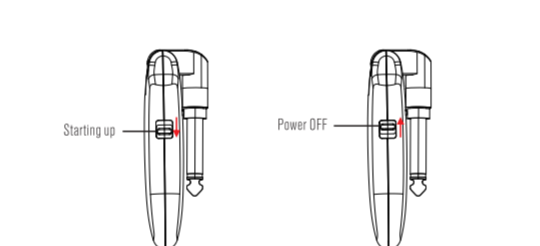

Device charging

Our product uses polymer lithium battery. Please charge the product before using it. If not used for a long time, charge the product once or more than three months.

1. With Dual-ended USB cable that can charge both the receiver and transmitter, please choose 5V 2A adapter for charging;
2. When charging, the battery capacity is displayed as the picture.

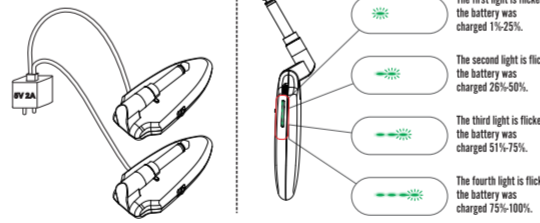

Device Testing

Connect the transmitter to the musical instruments and the receiver to the sound. Starting up start button of transmitter and receiver, the green lights of the transmitter and receiver always keeps on, enter normal working condition. If the following situations occurs, please solve as follows.

Not pairing successfully: If the transmitter green light keeps on and the receiver red light flashing, proves that the pairing is not successful. Should restart the transmitter and receiver.

No sound after pairing: If there is no green light on both the transmitter and receiver, no sound when playing, you can try to re-pairing the products.

Device frequency hopping
When using the device, there are signal interference around the device that causes the device not work properly. Frequency hopping can be performed on the device.

Check battery capacity

- When the device is started up, double-click the front button, and the four green lights on the side will display the current power information, which will be off after 3 seconds.

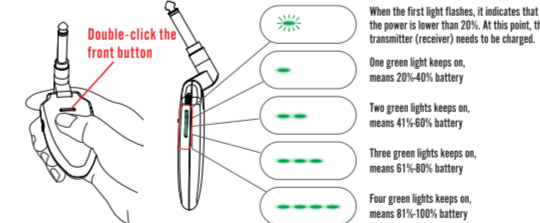

Reset code pairing

This product has been set by default before delivery and can be used directly after starting up. If the product can't be used directly, try to reset the code.

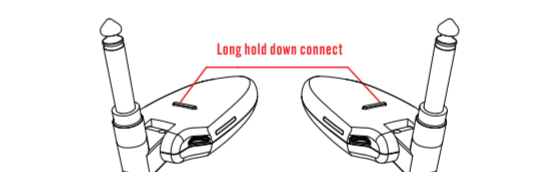

Pair code: When a transmitter connected with multiple receiver or transmitter and receiver are not the original equipment, can be long press on the code button to red light flashing, when transmitting terminal and receiving end normally on a green light, namely to code success!

More on other features

This system can support 10 sets to use at the same time without interference (above 500Hz). When using multiple equipment please turn on and test the wireless transceiver one to one to avoid signal crossing. After the test of each pair of wireless system is completed, then start and test the next pair of wireless system. If there is any signal interference during test period, can choose Frequency hopping key to frequency hopping.

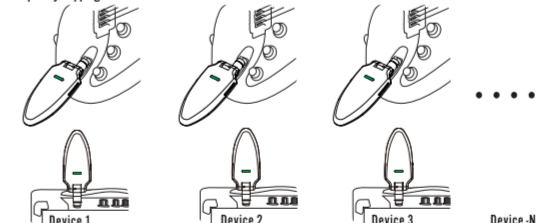

Device debugging

- A WX502 transmitter can be used with multiple WX502 receivers.
For example: There are four effects on a stage, you can use one WX502 transmitter and four WX502 receivers. Connect and performances at the same time.

Device debugging:
After shutting down all other quasi-wireless devices, long press the multi-function buttons of the four receiving devices until the red light flashes and release the buttons. Then long press the multi-function button of the transmitter device until the red light flashes at the transmitter and then release the button. It takes about 20 seconds to release the button. When the transmitter and all the receivers are green on, the four receivers can receive the signal of one transmitter and realize the function of 1-to-many. All code debugging time should be completed within 20 seconds. Functions can be realized. All code debugging time should be completed within 20 seconds.

